



Bell Hydromatics

Flow Control with Check Valves



Dimensions

G02-*** Flow Control with Check Valves (Axial Cam Operated, Push Down)

Pressure Compensated (Sub -plate type)

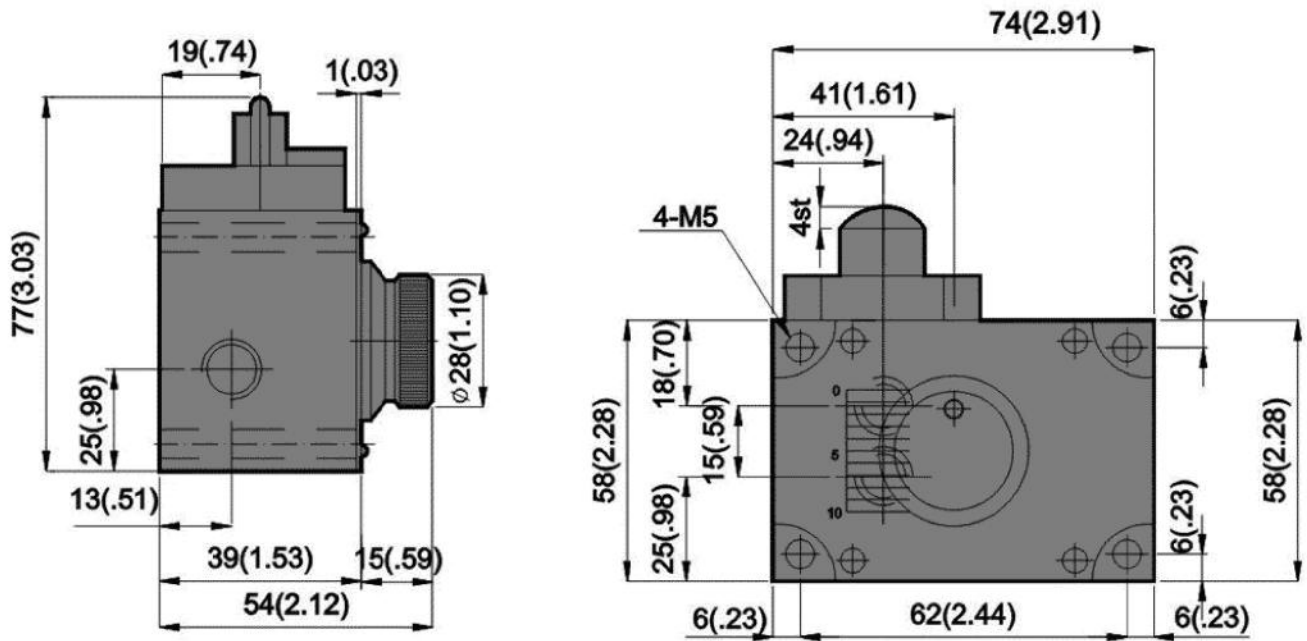

Sub-plate Dimensions

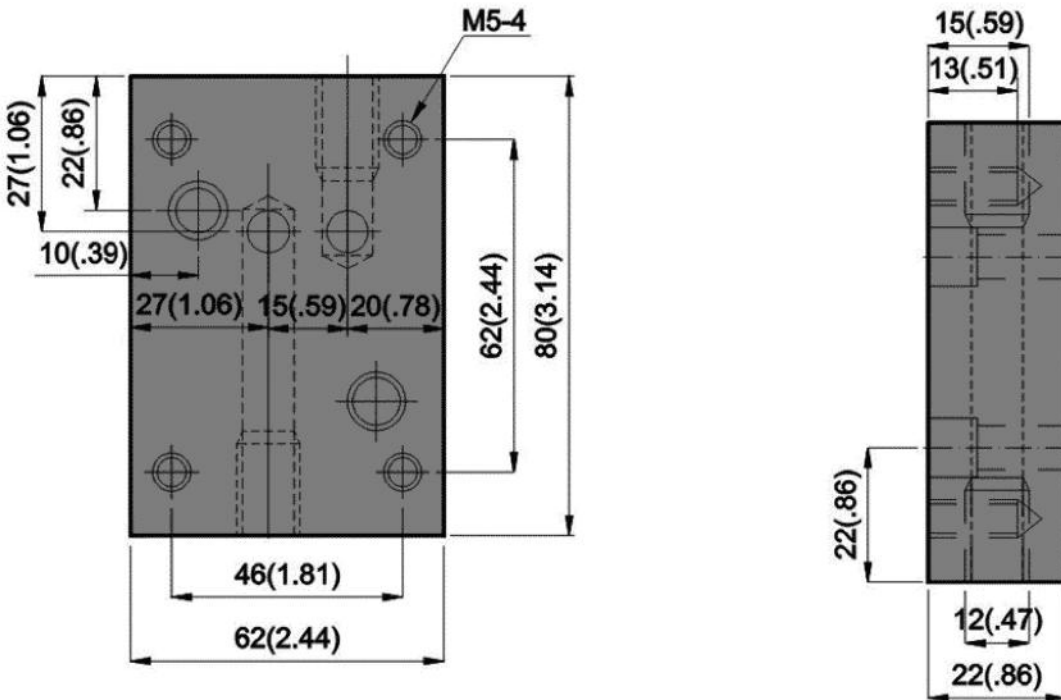

G02-***-02A Flow Control with Check Valves (Rotary Operated)

Pressure Compensated (Sub-plate type)

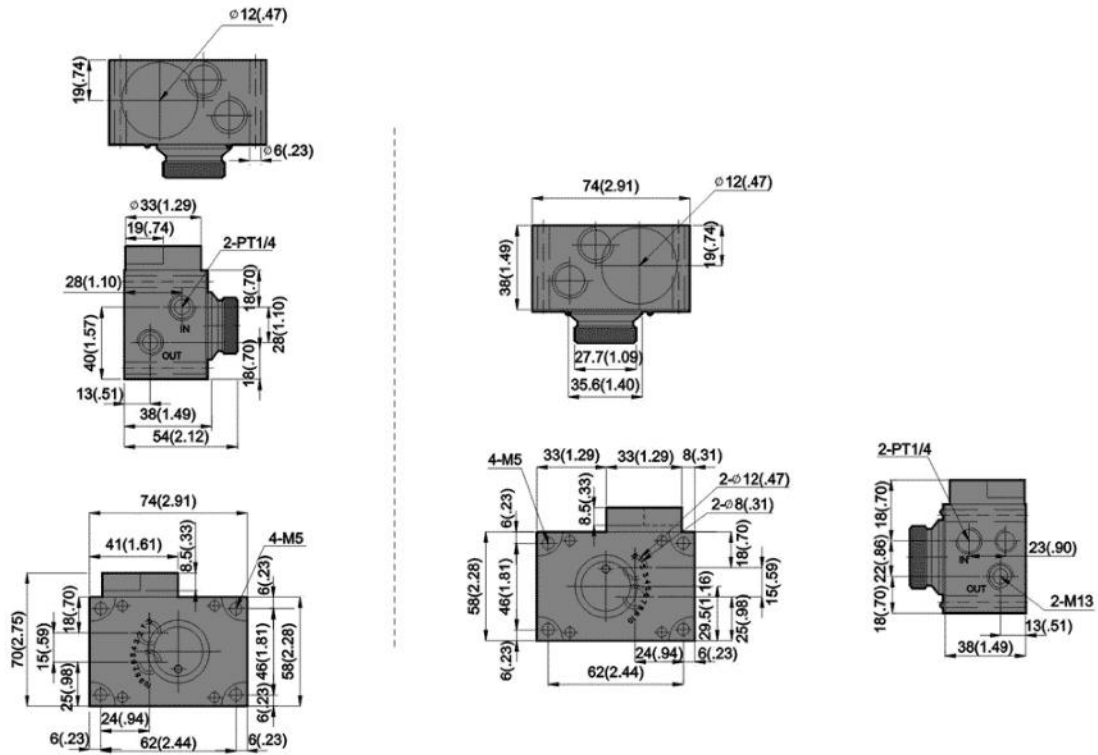

G02-***-02B Flow Control with Check Valves (Single Stage)

Pressure Compensated (Sub-plate type)

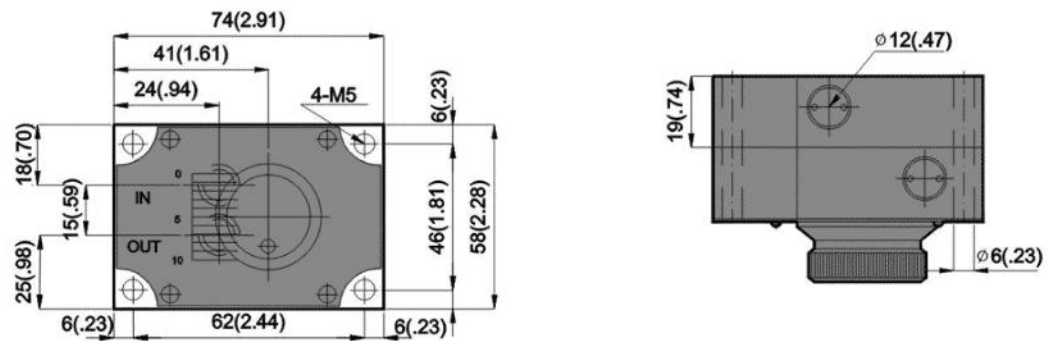

Sub-plate Dimensions

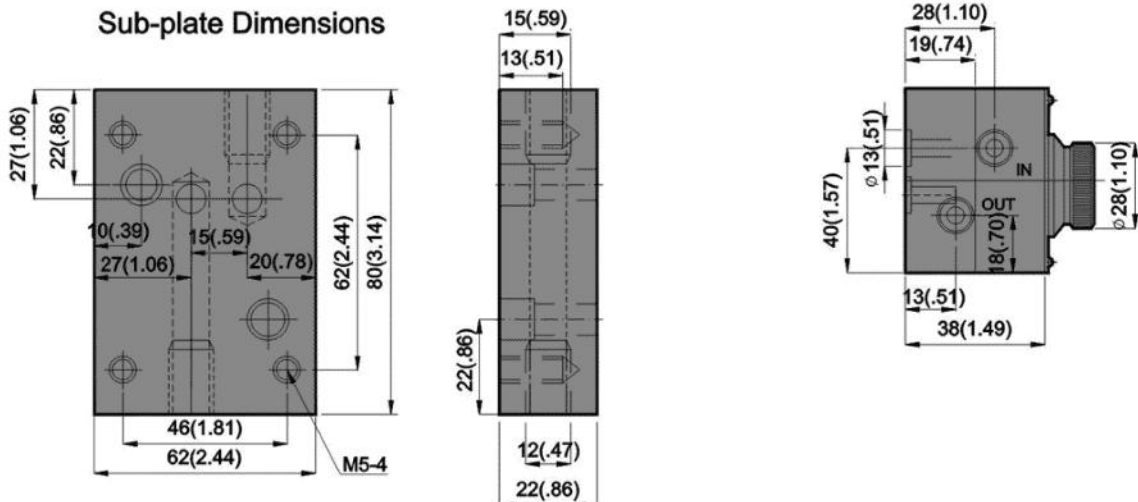

G02-***-02B2 Flow Control with Check Valves (Two Stage)

Pressure Compensated (Sub -plate type)

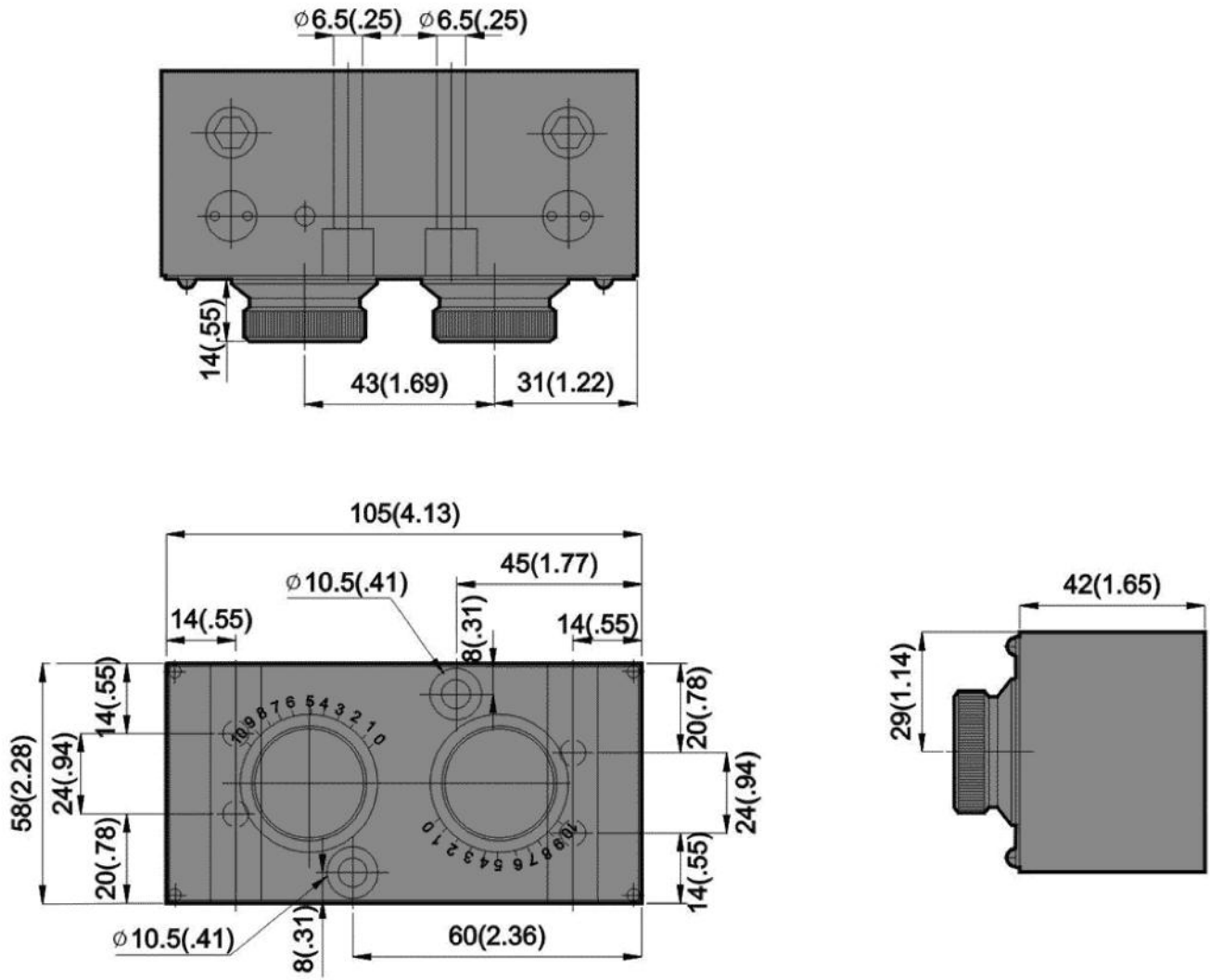

Valve Specifications and Attachment

G02-*** Flow Control with Check Valves (Axial Cam Operated, Push Down)

Pressure Compensated (Sub -plate type)

Model	FKC-G02-***
Free Flow	20lpm (5.2gpm)
Max. Pressure	70bar (1000 PSI)
Weight kg(lbs.)	1.96 (4.31)
CODE : 20	M6X45LgX4pcs
Surface O-ring	P12X2pcs

Model	Within Flow Rate Adjusting (lpm)	Connection Bore
-G02-001-02	0.1 – 1	PT 1/4
-G02-002-02	0.1 – 2	
-G02-004-02	0.1 – 4	

G02-***-02A Flow Control with Check Valves (Rotary Operated)

Pressure Compensated (Sub -plate type)

Model	FKC-G02-***-02A*
Free Flow	20lpm (5.29gpm)
Max. Pressure	70bar (1000 PSI)
Weight kg(lbs.)	2.40 (5.28)
CODE : 20	M5X45LgX4pcs
Surface O-ring	P10X2pcs

Model	Within Flow Rate Adjusting (lpm)	Connection Bore
-G-02001-02A(L)	0.1 – 1	PT 1/4
-G-02002-02A(L)	0.1 – 2	
-G-02004-02A(L)	0.1 – 4	
-G-02001-02LA	0.1 – 1	PT 1/4
-G-02001-02LA	0.1-2	
-G-02001-02LA	0.1-4	

G02-***-02B Flow Control with Check Valves (Single Stage)

Pressure Compensated (Sub -plate type)

Model	FKC-G02-***-02B
Free Flow	20lpm (5.2gpm)
Max. Pressure	70bar (1000 PSI)
Weight kg(lbs.)	2.30 (5.06)
CODE : 20	M5X45LgX4pcs
Surface O-ring	P10X2pcs

Model	Within Flow Rate Adjusting (lpm)	Connection Bore
-G02-001-02B	0.1 – 1	PT 1/4
-G02-002-02B	0.1 – 2	
-G02-004-02B	0.1 – 4	

-G02-*-02B2 Flow Control with Check Valves (Two Stage)**

Pressure Compensated (Sub -plate type)

Model	FKC-G02-***-02B2
Free Flow	20lpm (5.2gpm)
Max. Pressure	70bar (1000 PSI)
Weight kg(lbs.)	1.32 (2.90)
CODE : 20	M6X45LgX2pcs
Surface O-ring	P10X4pcs

Model	Within Flow Rate Adjusting (lpm)	Connection Bore
-G02-001-02B2	0.1 – 1	PT 1/4
-G02-001-02B2	0.1 – 2	
-G02-001-02B2	0.1 – 4	